

BLOCK 13, GERSHWIN IV

Amsterdam Zuid, the Netherlands
2011

FUNCTION:
Apartments

CLIENT:
Ymere Housing/De Complete stad

CONTRACT VALUE:
€7 million Euros

AREA:
6,500 m²

COST/m²:
€1076 Euro/m²

Block 13, Gershwin IV is a new €7 million 6 storey apartment building on the southern edge of a major new urban development of flats and offices in the district of Amsterdam Zuid.

The building accommodates 34 luxury flats. Overlooking a canal it is a low rise building and one of the smallest in its neighbourhood.

Our intention has been to orientate as many flats as possible towards the sunny south overlooking the canal. A number of studies of different building types were explored before deciding on a U-shaped plan building, which steps back in section towards the north and the taller neighbouring buildings along Gershwinlaan. This stepping back allows for very large south facing terraces with views of the canal. Terrace balustrades will be planted to give privacy and each 1.5 m cantilever provides shading to the full height glazing of the flat below.

Within the building's 6 storeys there are a variety of different sized flats, from one to three-bedroom flats. The penthouse flats on the fifth and sixth floor have unique lift access and are designed to maximise space in the south facing living room.

The main feature of the building is its large south facing terraces and the planted courtyard.

While on the south side the gardens and terraces dominate the elevation, it is the horizontality of the façade arrangement which dominates the east, west and north facades. Materials include Belgian blue stone, light bronze anodized windows and reeded light bronze anodised aluminium fixed panels, marble colonnades, grey glass balustrades and a light coloured Eternit for the internal lining of loggias and balconies.

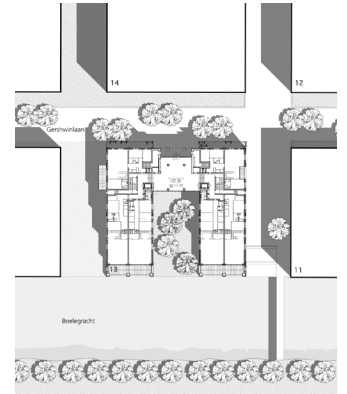

Location plan



View from the west



View from the Boelegracht canal